

Courses Beginning at a marked Hickory a Corner of Samuel Knox's Land and thence as follows ~

- No. 1 S. 45° E. 9.6 P^s To Post.
- No. 2 N. 37° E. 32. P^s To Hick^y.
- No. 3 S. 62 1/4° E. 38.4 P. Post.
- No. 4 N. 85 1/4° E. 26.6 P^s Post.
- No. 5 N. 23° E. 48. P^s Post.
- No. 6 S. 80° E. 58. P^s Post on the Manor Line.
- No. 7 N. 2° W. 122. P^s Post in Do.
- No. 8 S. 87° W. 24.2 P Post.
- No. 9 N. 9° E. 19. P^s Stones.
- No. 10 S. 49° W. 44. P^s Hick^y.
- No. 11 S. 9° W. 46.2 P^s Hick^y.
- No. 12 S. 28° W. 47.8 P^s Hick^y.
- No. 13 S. 52 1/4° W. 50. P^s Small Hick^y.
- No. 14 S. 41 1/4° W. 45. P^s To the Beginning.

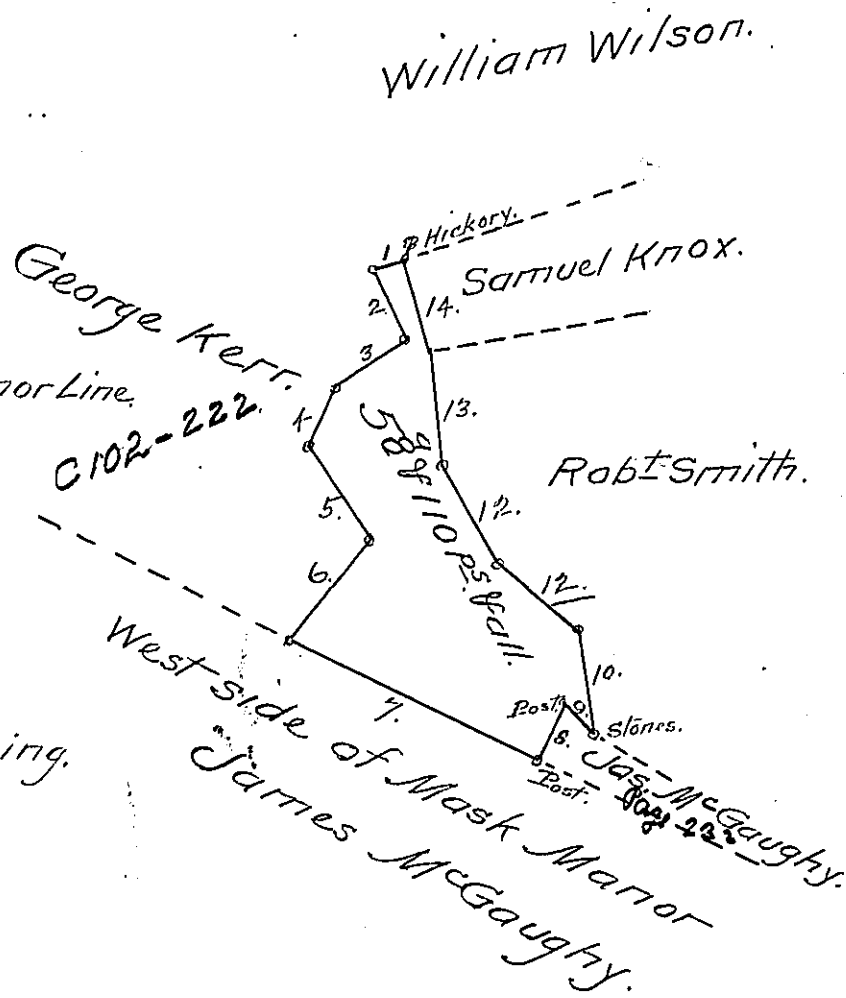

Situated in Hamilton Bann Township York County and Surveyed the 21st Day of October 1786 In pursuance of a Warrant Dated the 12th Day of June 1786

By Moses McClean D.Syr.

To John Lukens Esq^r Surveyor Gen^l.

IN TESTIMONY that the above is a copy of the original remaining on file in the Department of Internal Affairs of Pennsylvania, made conformably to an Act of Assembly approved the 16th day of February, 1833, I have hereunto set my Hand and caused the Seal of said Department to be affixed at Harrisburg, this tenth day of January 1906.

Isaac B. Brown
Secretary of Internal Affairs.